

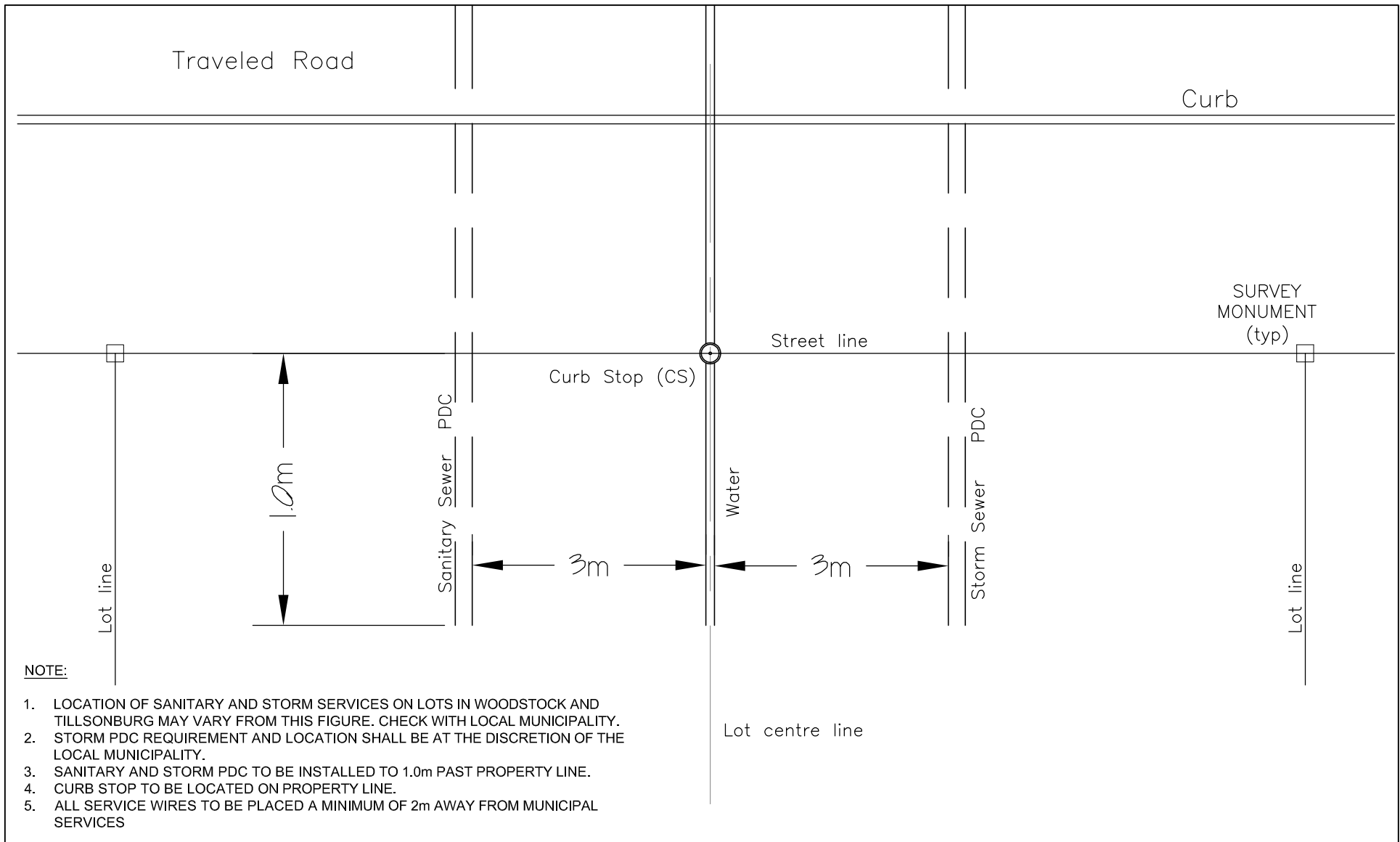

SECTION 1 – GENERAL

FIGURES



OXFORD COUNTY

SERVICE LOCATIONS SINGLE FAMILY RESIDENTIAL

DWG FIG 1.1.1

DATE NOV 2008

REV

1

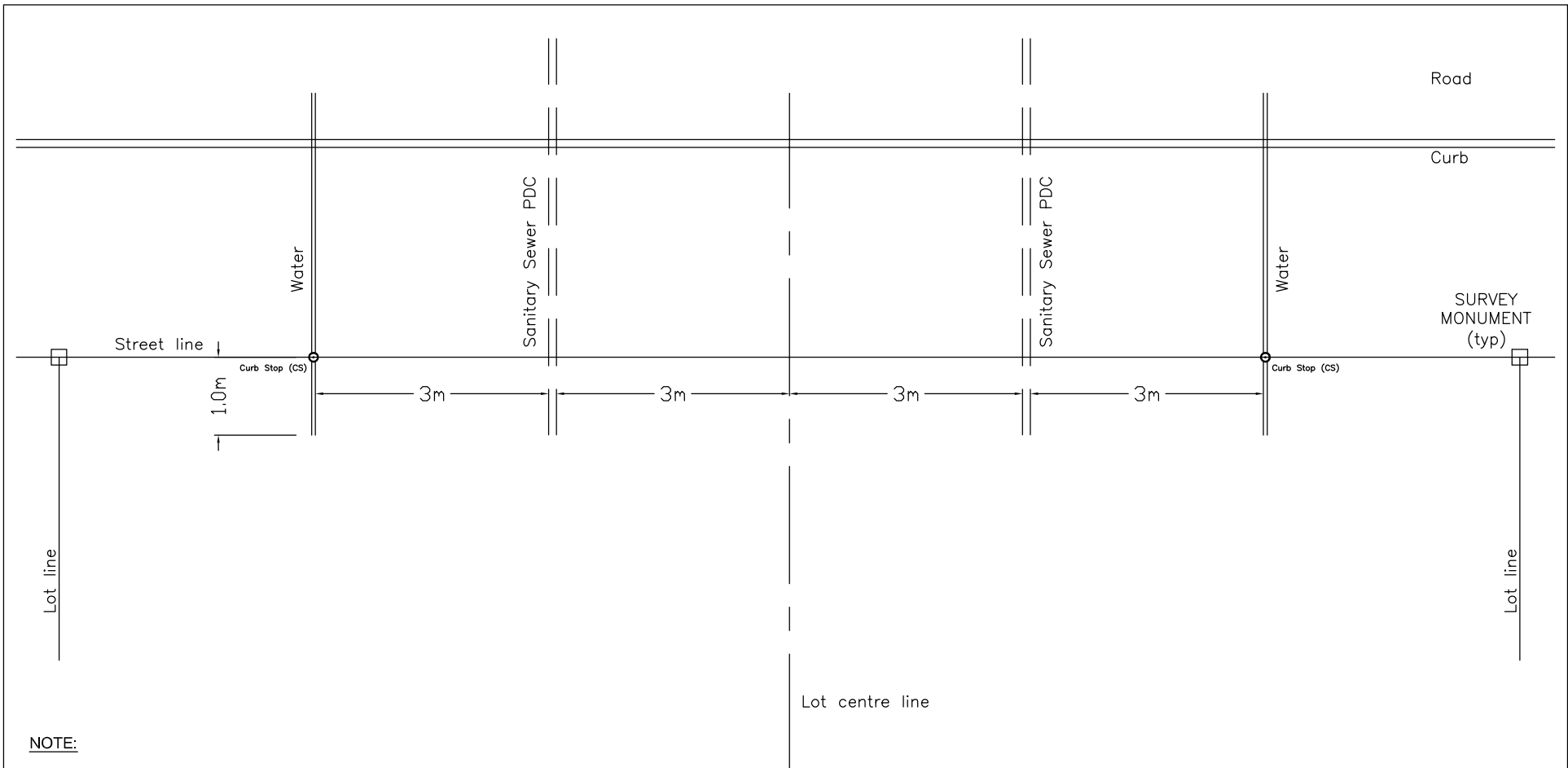

NOTE:

1. LOCATION OF SANITARY AND STORM SERVICES ON LOTS IN WOODSTOCK AND TILLSONBURG MAY VARY FROM THIS FIGURE. CHECK WITH LOCAL MUNICIPALITY.
2. STORM PDC REQUIREMENT AND LOCATION SHALL BE AT THE DISCRETION OF THE LOCAL MUNICIPALITY.
3. SANITARY AND STORM PDC TO BE INSTALLED TO 1.0m PAST PROPERTY LINE.
4. CURB STOP TO BE LOCATED ON PROPERTY LINE.
5. ALL SERVICE WIRES TO BE PLACED A MINIMUM OF 2m AWAY FROM MUNICIPAL SERVICES

OXFORD COUNTY

SERVICE LOCATIONS-SEMI DETACHED RESIDENTIAL

DWG	FIG 1.1.2	DATE	APRIL 2016
			REV
			<div style="border: 1px solid black; width: 30px; height: 30px; margin: 0 auto; display: flex; align-items: center; justify-content: center;"> 0 </div>

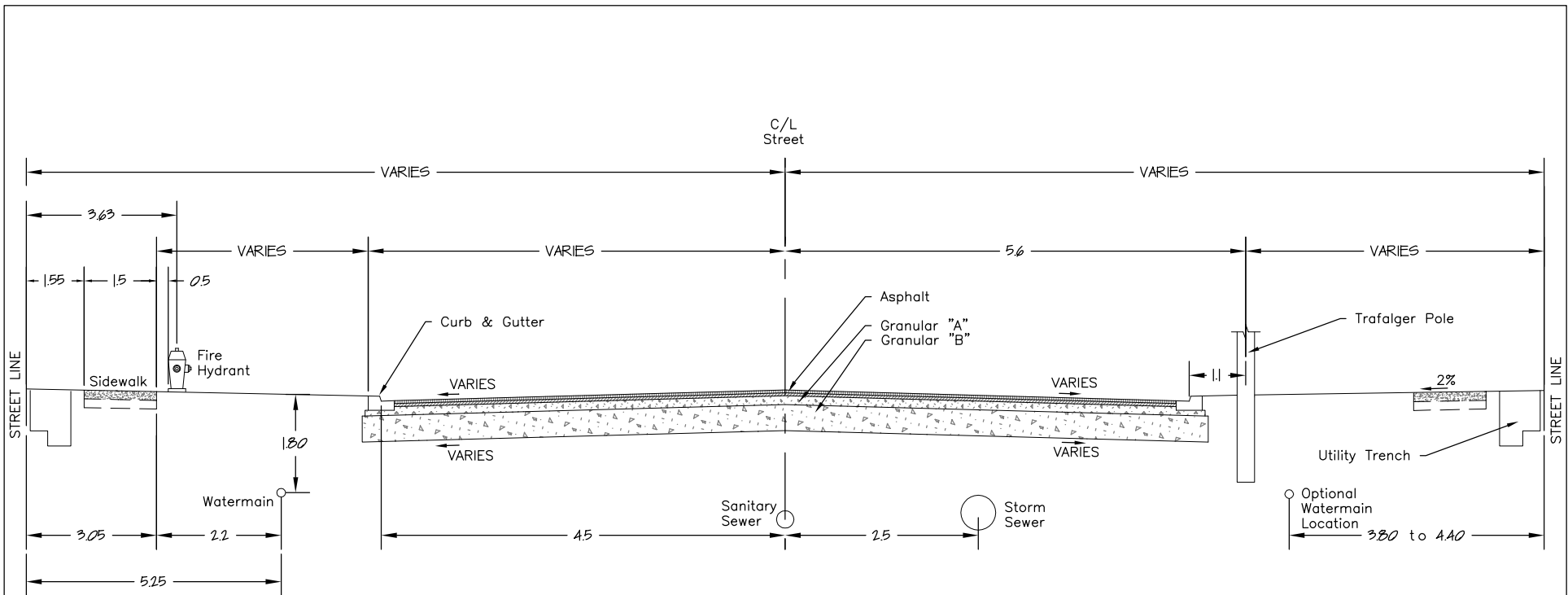

TYPICAL SECTION - ARTERIAL STREET
N.T.S.

NOTE:

All Dimensions are in Metres Unless Otherwise Shown.
 Curb and Gutter to Meet O.P.S.D.
 Street Light Standards on Alternate Sides of the Road.
 Trafalgar Poles to be located not less than 2.0m either side of hydrant laterals.

OXFORD COUNTY

TYPICAL RESIDENTIAL ROAD SECTION

DWG FIG 1.2.1

DATE NOV 2008

REV

1

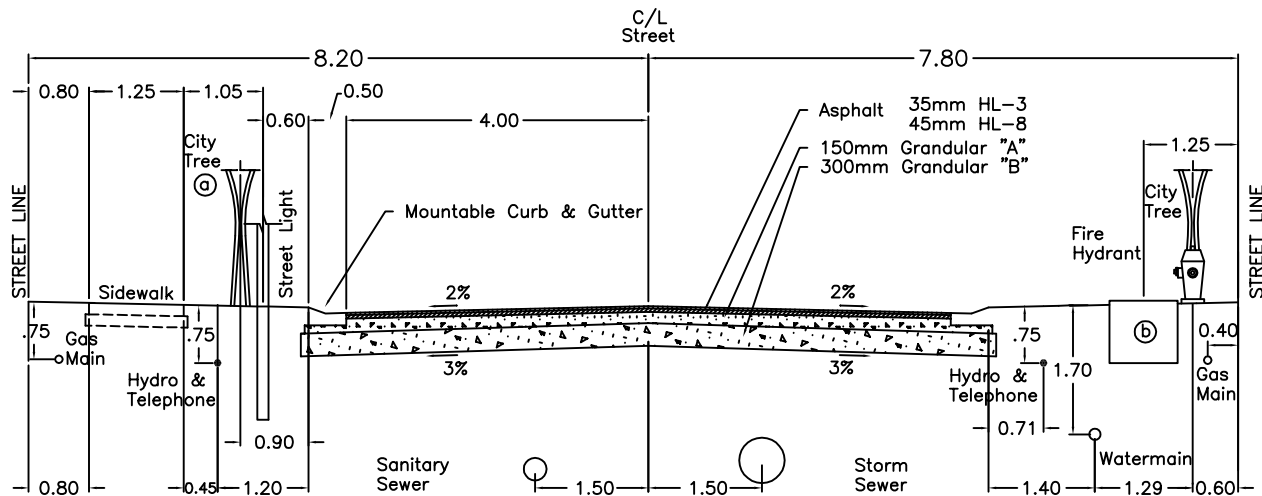

TYPICAL SECTION FOR 16.00m ROAD ALLOWANCE
1:100(Metric)

- Ⓐ City Tree to be placed Between mid-points of street light locations.
- Ⓑ 0.9 SQ. Mini transformer pad to be 0.10 above grade 0.75 deep

NOTE:

All Dimensions are in Metres Unless Otherwise Shown.
Curb and Gutter to Meet O.P.S.D.
Sidewalks to be built on opposite side of street from Watermain, and extend to, and around Cul-de-sac to Pedestrian Access if one is provided.

**CITY OF WOODSTOCK
ENGINEERING DEPARTMENT**

Date: February 6, 2003

FIG 1.2.2

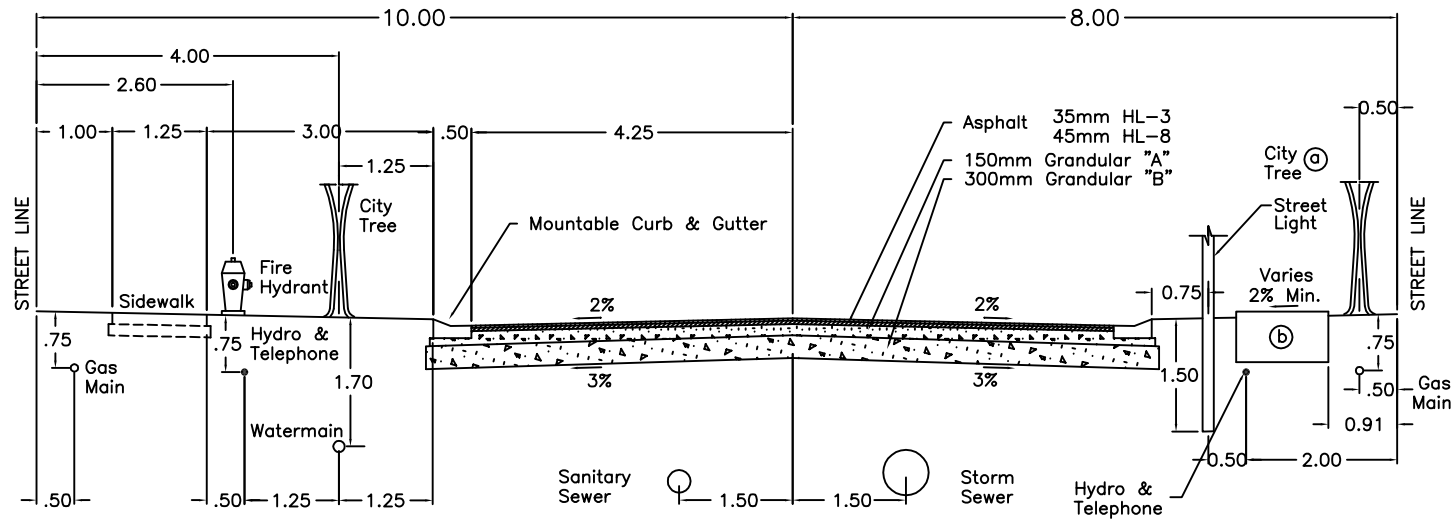

TYPICAL SECTION FOR 18.00m ROAD ALLOWANCE

LOCAL STREET

1:100(METRIC)

- Ⓐ City Tree to be placed between mid-points of street light locations
- Ⓑ 1.20 ∅ Transformer Pad to be .10 Above Ground .75 Deep

NOTE:

All Dimensions are in Metres Unless Otherwise Shown.
Curb and Gutter to Meet O.P.S.D.
Street Lights Standards on Alternate Sides of the Road.

CITY OF WOODSTOCK
ENGINEERING DEPARTMENT

Date: February 6, 2003

FIG 1.2.3

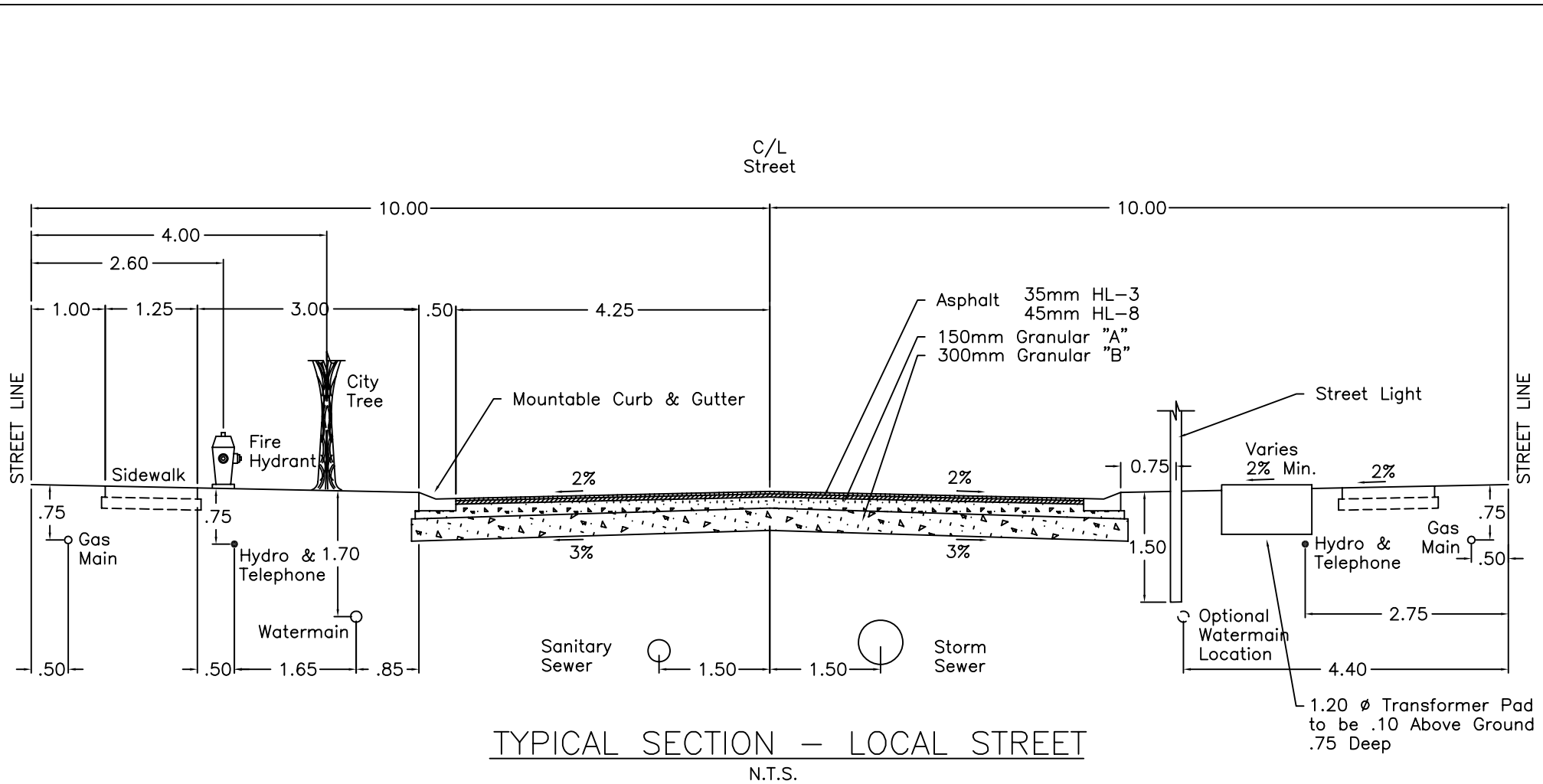

NOTE:

All Dimensions are in Metres Unless Otherwise Shown.
 Curb and Gutter to Meet O.P.S.D.
 Street Lights Standards on Alternate Sides of the Road.

			CITY OF WOODSTOCK ENGINEERING DEPARTMENT
			TYPICAL SECTION LOCAL STREET
3	February 6, 03	BMc	CITY ENGINEER
2	JULY 91	D.A.	
1	MARCH 91	D.A.	
REVISIONS			DATE : Aug. 1978
			ST-404

FIG 1.2.4

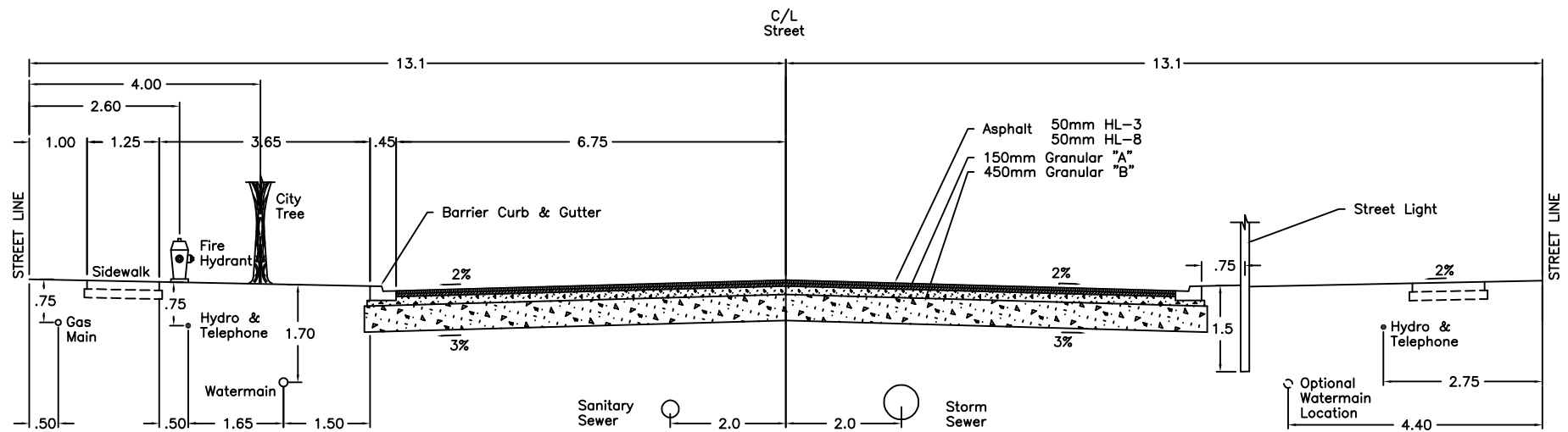

TYPICAL SECTION – ARTERIAL STREET

N.T.S.

NOTE:

All Dimensions are in Metres Unless Otherwise Shown.
 Curb and Gutter to Meet O.P.S.D.
 Street Lights Standards on Alternate Sides of the Road.

FIG 1.2.5

			CITY OF WOODSTOCK ENGINEERING DEPARTMENT	
			TYPICAL CROSS SECTION OF 26m ROAD ALLOWANCE WITH 14m PAVEMENT FOR 4 LANE ARTERIAL	
2	JULY 90'	D.A.	CITY ENGINEER	ST-403
1	MARCH 90'	D.A.		
REVISIONS			DATE :SEPT. 82'	

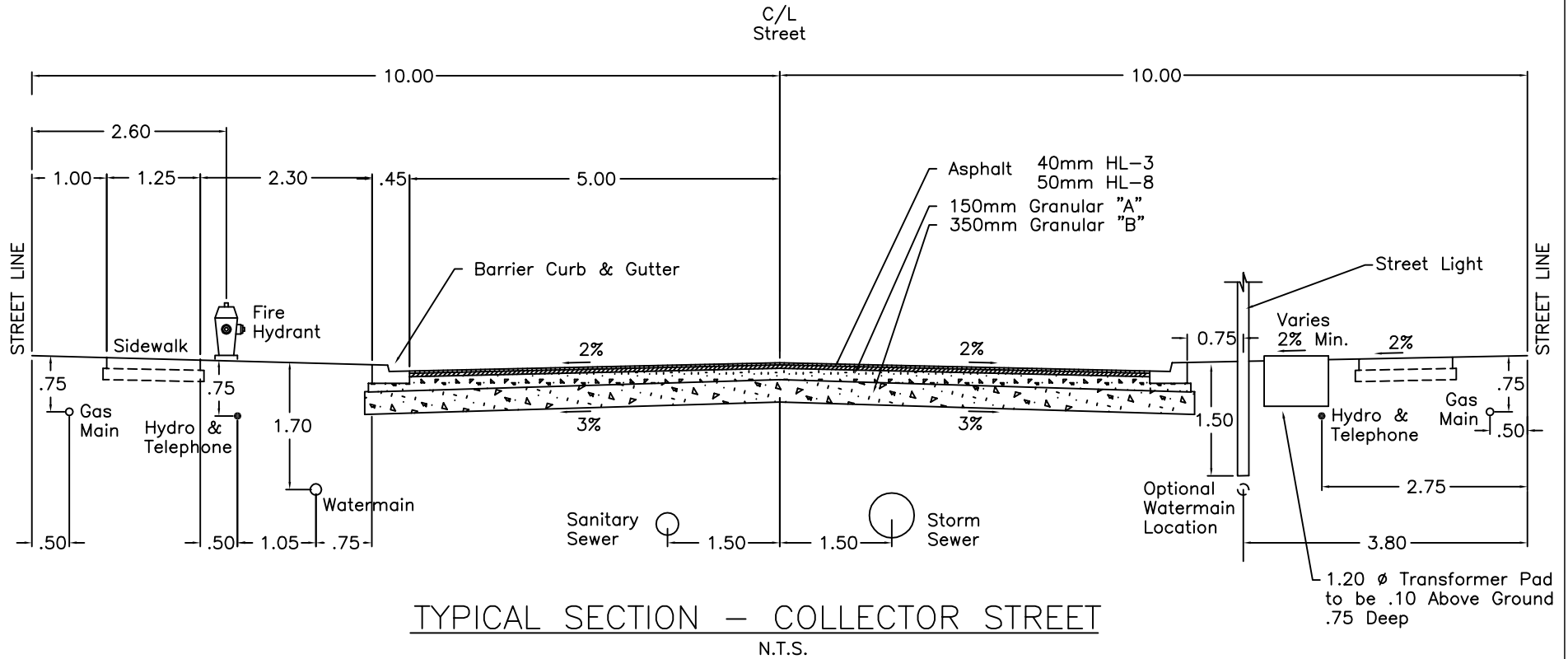

NOTE:

All Dimensions are in Metres Unless Otherwise Shown.
 Curb and Gutter to Meet O.P.S.D.
 Street Lights Standards on Alternate Sides of the Road.

FIG 1.2.6

			CITY OF WOODSTOCK ENGINEERING DEPARTMENT
			TYPICAL SECTION COLLECTOR STREET
			CITY ENGINEER
			ST-405
2 JULY 90' D.A. 1 MARCH 90' D.A.	REVISIONS	DATE : SEPT.1978	

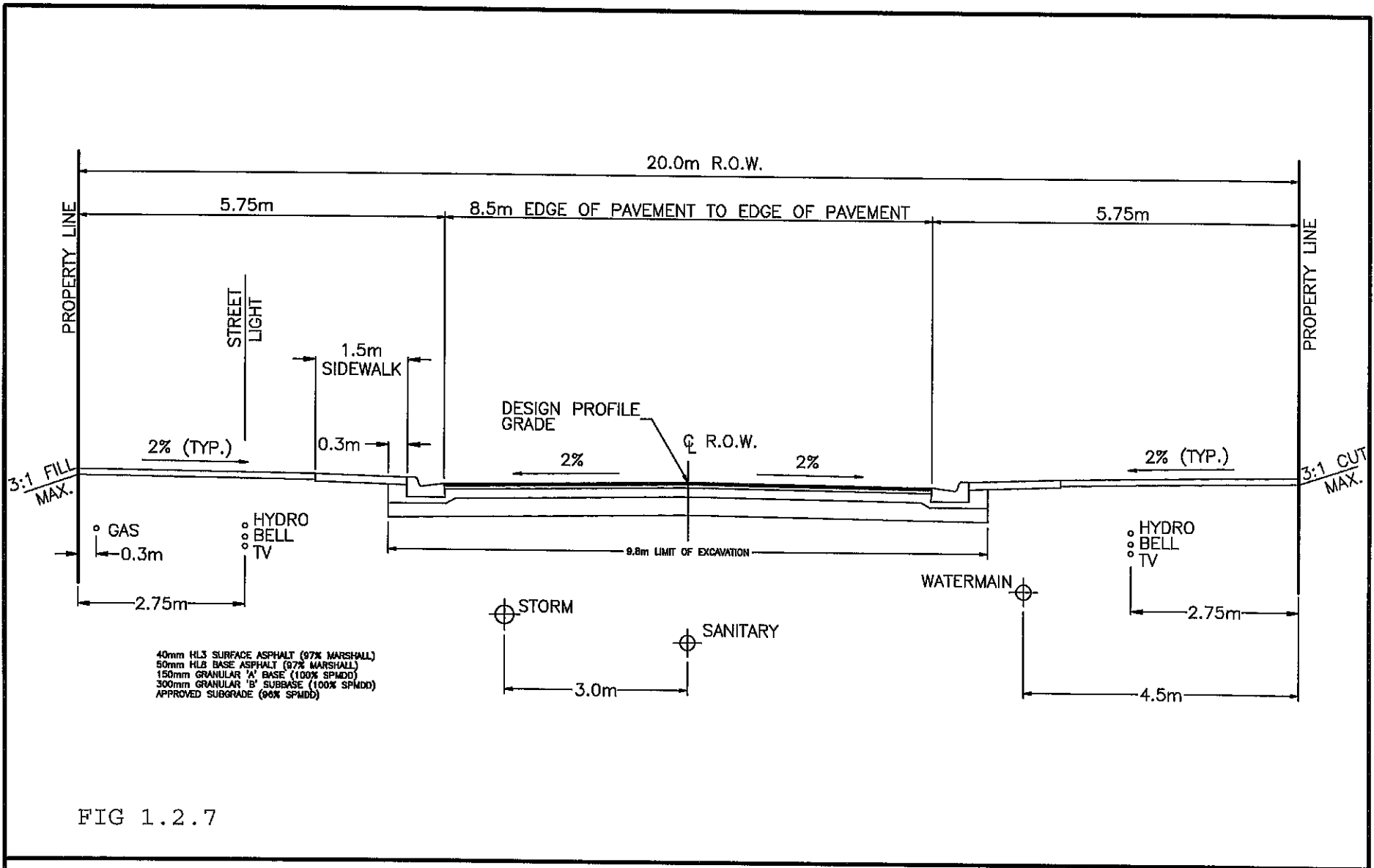

FIG 1.2.7

TYPICAL X-SECTION – LOCAL

DRAWING: K:\DESIGN CRITERIA\...\TYPICAL X-SECTION.DWG	DATE:	APPROVED BY:
---	-------	--------------

TOWN OF TILLSONBURG
CUSTOMER SERVICE CENTRE
 10 LISGAR AVENUE, TILLSONBURG, ONTARIO, N4G 5A5

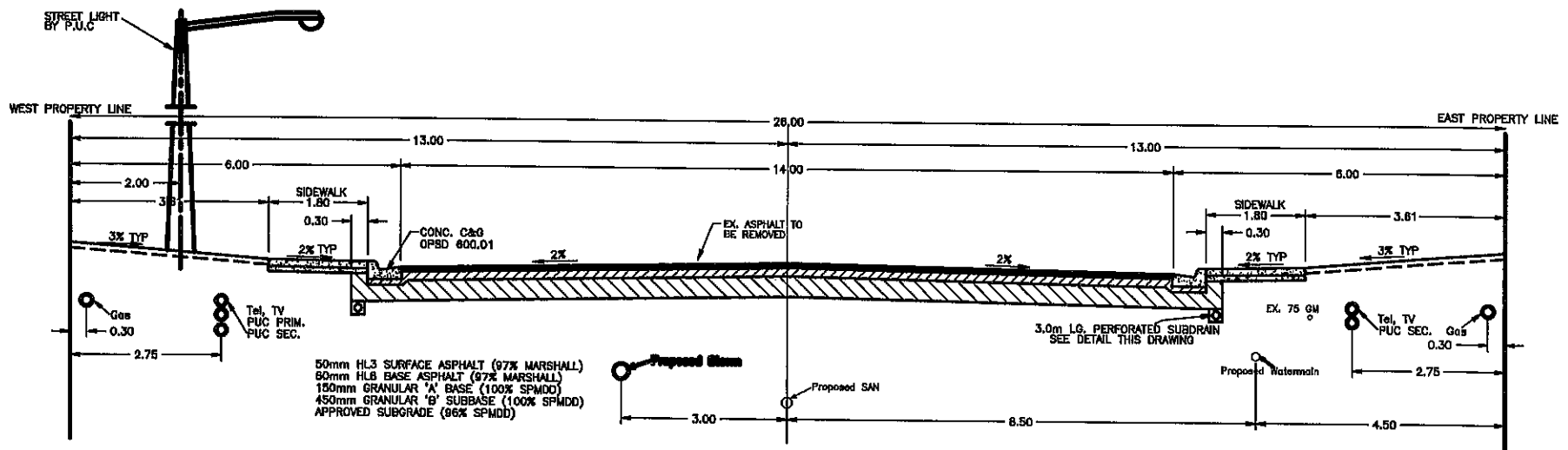

FIG 1.2.8

TYPICAL X-SECTION - ARTERIAL

DRAWING: K:\DESIGN CRITERIA\...\TYPICAL X-SECTION.DWG

DATE: May 7, 2007

APPROVED BY:

TOWN OF TILLSONBURG
COMMUNITY SERVICES
CUSTOMER SERVICE CENTRE
 10 LISGAR AVENUE, TILLSONBURG, ONTARIO, N4G 5A5

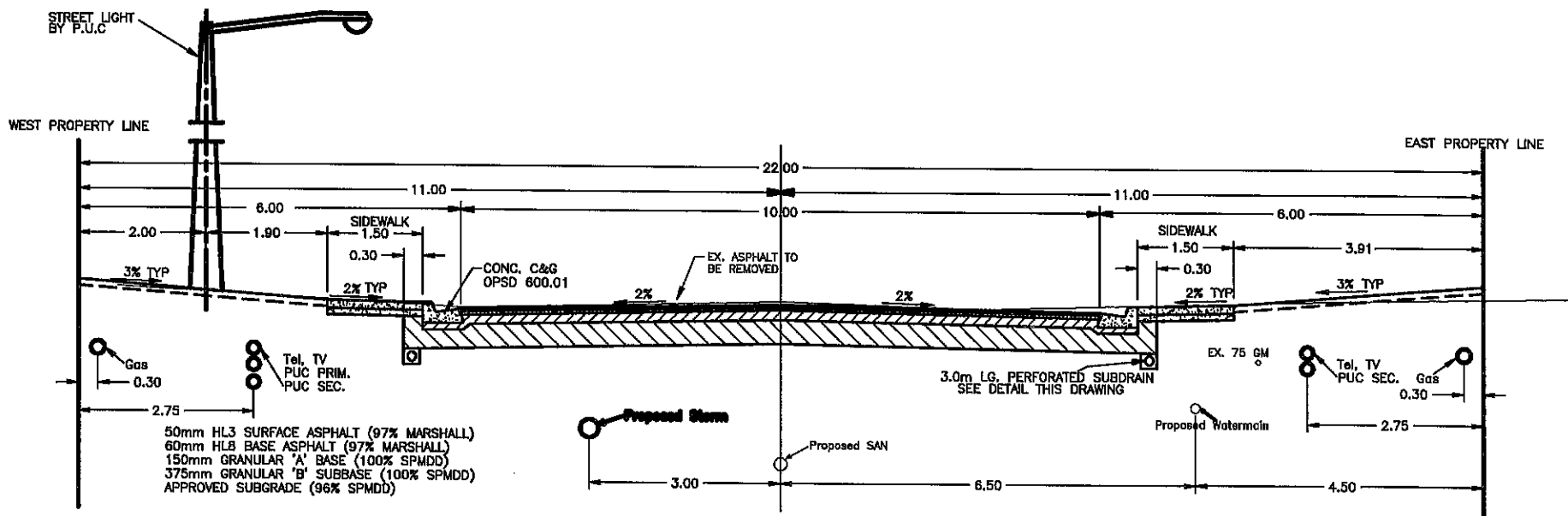

FIG 1.2.9

TYPICAL X-SECTION - COLLECTOR

DRAWING: K:\DESIGN CRITERIA\...TYPICAL X-SECTION.DWG

DATE: May 4, 2007

APPROVED BY:

TOWN OF TILLSONBURG
CUSTOMER SERVICE CENTRE
 10 LISGAR AVENUE, TILLSONBURG, ONTARIO, N4G 5A5

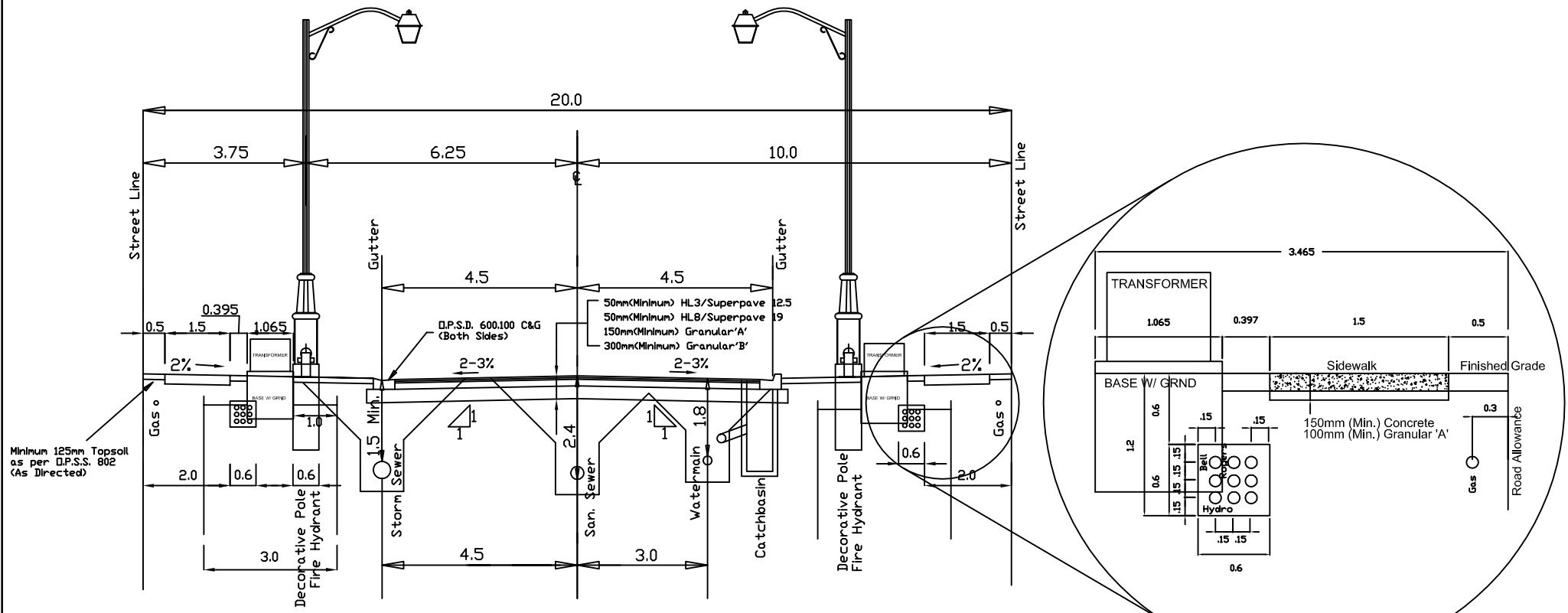

Typical 20m Cross-Section

N. T. S.
 Approved March, 2012
 Revised September, 2014

No.	BY	DATE	DESCRIPTION
6.		2012	Approved by Council (May14th)
5.	WK	2012	Utility Change
4.	TWE	2009	Crossfall Change
3.	JLA	01/04	Hydrant, S/W & Utilities Relocated
2.	ERM	01/98	Sidewalk Width- Preferred & Min'm
1.	EAB	01/93	Walks & Hydrants Relocated

REVISIONS

METRIC: ALL DIMENSIONS ARE IN METRES AND/OR MILLIMETRES UNLESS OTHERWISE NOTED.

The Corporation of The Town of Ingersoll

Typical 20m - Residential Standard
 Local Cross Section

DRAWN BY: J.L.A.	APPROVED BY: E.R.M.	DATE: JAN.2004	STANDARD No. S-14
---------------------	------------------------	-------------------	----------------------

Figure 1.3 Sanitary, Water & Storm Service Record

- In-Service
- Spare
- Abandoned
- Blow-Off
- Future

Municipality:		
Municipal Street & Number:	Lot Number:	
Sewer Lateral Material & Size (Main to P/L)	Collection Pipe Size & Material:	Distance from upstrm / dwnstrm MH _____ Main Sewer Tee installed Yes <input type="checkbox"/> No <input type="checkbox"/> Sewer Clean-out Installed Yes <input type="checkbox"/> No <input type="checkbox"/> Lateral into MH Yes <input type="checkbox"/> No <input type="checkbox"/> Proper connection at Property Line Yes <input type="checkbox"/> No <input type="checkbox"/> Septic tank abandoned properly Yes <input type="checkbox"/> N/A <input type="checkbox"/>
Date Installed:	Inspected By:	
Sewer Service Later Material & Size (P/L to Bldg)		
Date Installed:	Inspected By:	
Water Service Material & Size (Main to Curbstop Box)		
Date Installed :	Inspected By:	
Water Service Material & Size (Curbstop to Bldg)		
Date Installed:	Inspected By:	
Date Water Turned ON:		
Tapping saddle installed Yes <input type="checkbox"/> No <input type="checkbox"/> Trace wire (main to curbstop) Yes <input type="checkbox"/> N/A <input type="checkbox"/> Sand Bedding & Cover Material Yes <input type="checkbox"/> No <input type="checkbox"/> Old well properly abandoned Yes <input type="checkbox"/> N/A <input type="checkbox"/>		

Sketch of Service: (All measurements in metric) P/L = Property Line

+

Revision Date:	Revised By:
----------------	-------------

Sanitary, Water & Storm Service Record

- In-Service
- Spare
- Abandoned
- Blow-Off
- Future

Municipality: TAVISTOCK		
Municipal Street & Number: 555 MAIN ST	Lot Number: 5	
Sewer Lateral Material & Size (Main to P/L) 100mm SDR-35 PVC	Collection Pipe Size & Material: 200mm SDR-35	Distance from upstrm / dnstrm MH Main Sewer Tee installed Yes <input checked="" type="checkbox"/> No <input type="checkbox"/> Sewer Clean-out Installed Yes <input type="checkbox"/> No <input type="checkbox"/> Lateral into MH Yes <input type="checkbox"/> No <input type="checkbox"/> Proper connection at Property Line Yes <input type="checkbox"/> No <input type="checkbox"/> Septic tank abandoned properly Yes <input type="checkbox"/> N/A <input type="checkbox"/>
Date Installed: September 16, 2013	Inspected By: ABC Consultants / Contractor	
Sewer Service Lateral Material & Size (P/L to Bldg)		
Date Installed:	Inspected By:	
Water Service Material & Size (Main to Curbstap Box) Municipex 19mm dia.	Watermain Size & Material: 150mm DR-18 PVC	Tapping saddle installed Yes <input type="checkbox"/> No <input checked="" type="checkbox"/> Trace wire (main to curbstap) Yes <input checked="" type="checkbox"/> N/A <input type="checkbox"/> Sand Bedding & Cover Material Yes <input type="checkbox"/> No <input type="checkbox"/> Old well properly abandoned Yes <input type="checkbox"/> N/A <input type="checkbox"/>
Date Installed: September 16, 2013	Inspected By: ABC Consultants / Contractor	
Water Service Material & Size (Curbstap to Bldg)	Contractor:	
Date Installed:	Inspected By:	
Date Water Turned ON:		

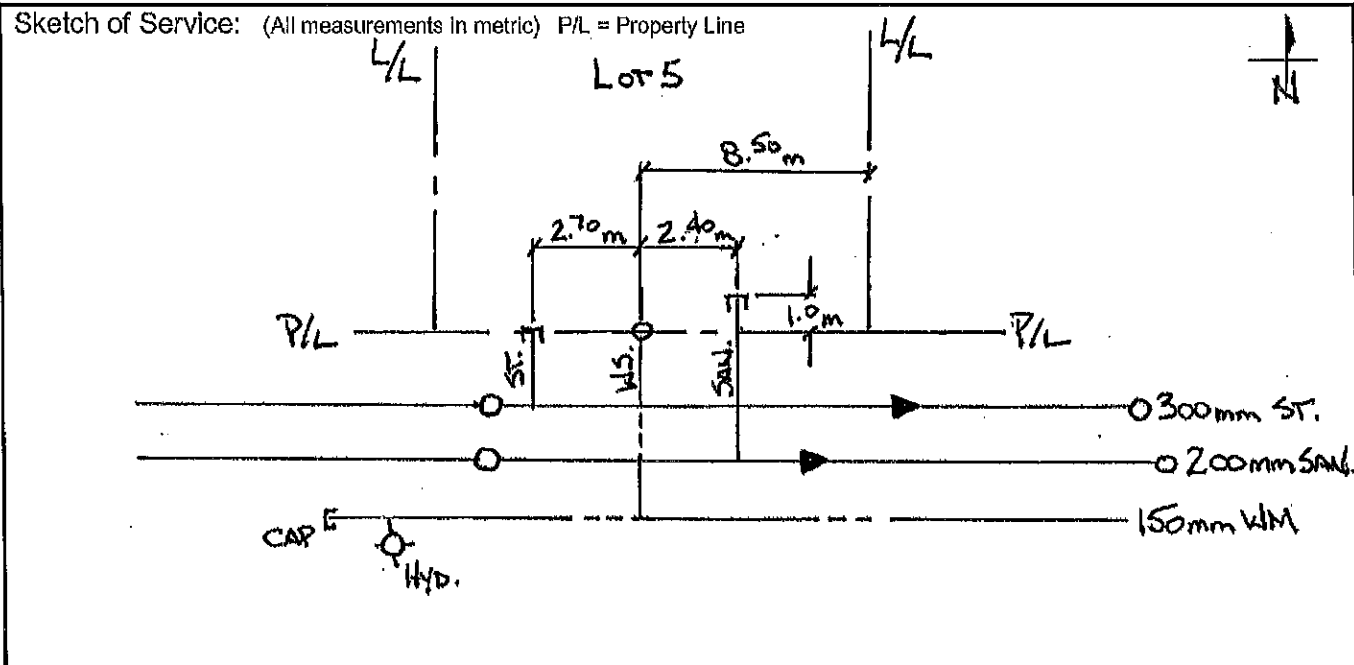

Revision Date:	Revised By:
----------------	-------------